

# **KGE**

2019

## **PRODUCTS BROCHURE**

**NUTS**

**Kay Guay Enterprises Co., Ltd.**

凱貴企業有限公司

No.12, Fushing W.Rd., Chiautou Dist.,  
Kaohsiung 82547 Taiwan

TEL: +886 7 6119470 FAX: +886 7 6131750

kayguay@kayguay.com www.kayguay.com

# Table Of Content

<b>01</b> Barrel nuts ◦	<b>03</b> Blind nuts ◦	<b>13</b> Cage nuts ◦
<b>15</b> Cap nuts ◦	<b>17</b> Hex flange nuts ◦	<b>19</b> Hex nuts ◦
<b>21</b> Insert nuts ◦	<b>31</b> Nylon Insert lock nuts ◦	<b>33</b> Plate nuts ◦
<b>37</b> Rivet nuts ◦	<b>41</b> Sleeve nuts ◦	<b>47</b> Square nuts ◦
<b>49</b> T nuts ◦	<b>53</b> Tube connecting nuts ◦	<b>63</b> Weld nuts ◦
<b>65</b> Wing nuts ◦		

# Barrel nuts

NU-BAR-01  
Material: Zamak



## Specifications

Imperial Unit				Metric Unit			
T	D	L	DRIVE	T	D	L	DRIVE
5/32	9.5	7	+	M4	9.5	7	+
3/16	8	10	-	M5	8	10	-
1/4	9.5	11	+	M6	9.5	11	+
1/4	10	11	-	M6	10	11	-
1/4	9.3	13	+	M6	9.3	13	+
1/4	9.5	13	+	M6	9.5	13	+
1/4	9.8	13	+	M6	9.8	13	+
1/4	10	13	+	M6	10	13	+
1/4	9.5	14	-	M6	9.5	14	-
1/4	9.5	15	+	M6	9.5	15	+
1/4	10	16	+	M6	10	16	+
1/4	10	20	+	M6	10	20	+
1/4	12	23	-	M6	12	23	-
5/16	12	15	-	M8	12	15	-
5/16	12	18	-	M8	12	18	-

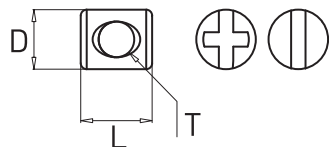

01

# Barrel nuts

NU-BAR-02  
Material: Steel



## Specifications

Imperial Unit				Metric Unit			
T	D	L	DRIVE	T	D	L	DRIVE
1/4	9.5	14	-	M6	9.5	14	-

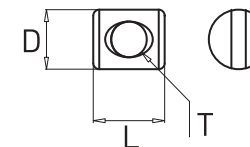

02

# Blind nuts

NU-BLD-02  
CSK Head  
Material: Steel



## Specifications

Metric Unit				HOLE SIZE	GAUGE
Thread	D1	D2	L		
M4	5.9	9	11.5	6	2.0-3.5
M5	6.9	10	13.5	7	2.0-4.0
M6	8.9	12	16.0	9	2.0-4.5
M8	10.9	14	19.0	11	2.0-4.5
M10	11.9	15	21.0	12	2.0-4.5

Imperial size is available by request

## Installation

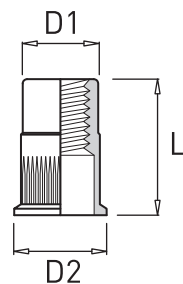
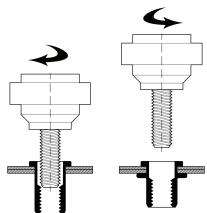

# Blind nuts

NU-BLD-03  
Reduced CSK Head  
Material: Steel



## Specifications

Metric Unit				HOLE SIZE	GAUGE
Thread	D1	D2	L		
M4	5.9	7	10.0	6	0.5-3.0
M5	6.9	8	11.5	7	0.5-3.0
M6	8.9	10	14.0	9	0.5-3.0
M8	10.9	12	15.5	11	0.5-3.0
M10	11.9	13.5	19.5	12	0.8-3.5

Imperial size is available by request

## Installation

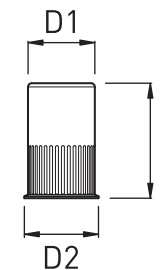
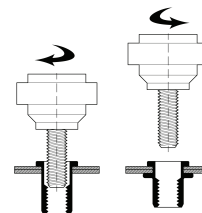

# Blind nuts

NU-BLD-04  
Cylindrical head serrated  
Material: Steel



## Specifications

Metric Unit					
Thread	D1	D2	L	HOLE SIZE	GAUGE
M3	4.9	8	9.5	5	1.0-2.5
M4	6.0	9	11	6.1	1.0-2.5
M5	6.9	10	13.5	7	0.5-3.0
M6	8.9	12	14.5/16.5	9	1.0-2.5 / 2.5-4.0
M8	11	15	18	11.1	0.8-3.5
M10	11.9	16	19.5/22	12	1.0-3.5 / 3.5-6.0

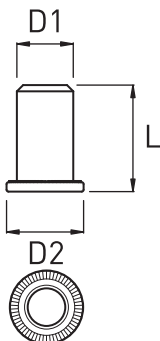

## Installation

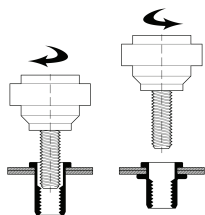

# Blind nuts

NU-BLD-05  
Cylindrical head hex body  
Material: Steel



## Specifications

Metric Unit					
Thread	D	W	L	HOLE WIDTH	GAUGE
M4	9.3	6	11.5	6.1	0.5-3.0
M5	10.3	7	13.5	7.1	0.5-3.0
M6	12.3	9	15.5	9.1	0.5-3.0
M8	14.3	11	17.5	11.1	0.5-3.0
M10	16.3	13	22.0	13.1	1.0-4.0

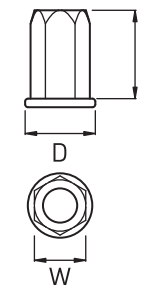

## Installation

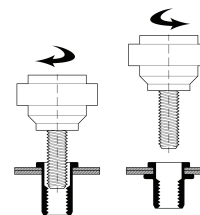

# Blind nuts

NU-BLD-06  
Reduced CSK head hex body  
Material: Steel



## Specifications

Metric Unit				
Thread	W	L	HOLE WIDTH	GAUGE
M4	6	12	6.1	0.5-3.0
M5	7	14	7.1	0.5-2.5
M6	9	16	9.1	0.5-2.5
M8	11	18	11.1	0.5-2.5
M10	13	22	13.1	0.5-4.0

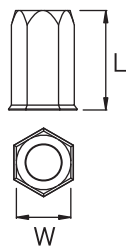

## Installation

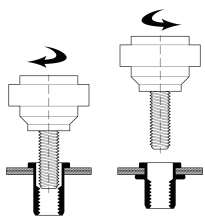

# Blind nuts

NU-BLD-01  
Cylindrical head knurled body  
Material: Steel



## Specifications

Metric Unit					
Thread	D1	D2	L	HOLE SIZE	GAUGE
M4	6.73	9.91	10.67/11.94	6.75	0.5-2.0/2.0-3.3
M5	7.52	10.54	12.07/14.86	7.6	0.5-3.3/3.3-5.7
M6	9.91	12.7	14.73/17.27	10	0.7-4.2/4.2-6.6
M8	13.46	17.4	17.53/20.45	13.5	0.7-3.8/3.8-7.9
M10	13.46	17.4	17.53/20.45	13.5	0.7-3.8/3.8-7.9
M12	17.40	21.97	29.21/33.02	17.45	1.6-5.1/5.1-8.9

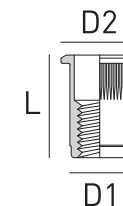

## Installation

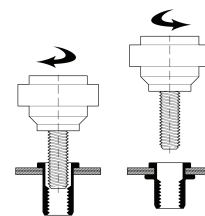

# Blind nuts

NU-BLD-04  
Semi-hexagon reduced CSK head  
Material: Steel



## Specifications

Metric Unit				
Thread	W	L	HOLE WIDTH	GAUGE
M4	6	11	6.1	1.5-2.5
M5	7	12	7.1	1.5-2.5
M6	9	14	9.1	1.0-2.5
M8	11	15.5	11.1	1.0-2.5
M10	13	18	13.1	1.0-2.5

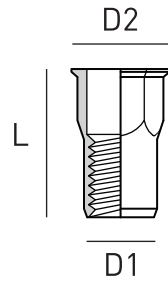

## Installation

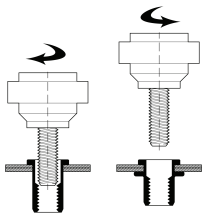

# Blind nuts

NU-BLD-05  
Reduced CSK head serrated  
Material: Steel



## Specifications

Metric Unit					
Thread	D1	D2	L	HOLE SIZE	GAUGE
M3	4.8	5.5	9	4.9	0.5-1.5
M4	6.32	7.2	10.4	6.4	0.5-1.5
M5	7.11	8.0	12	7.2	0.5-2.0
M6	9.45	10.7	15	9.6	0.8-2.5
M8	10.5	11.7	16	10.6	1.0-3.0

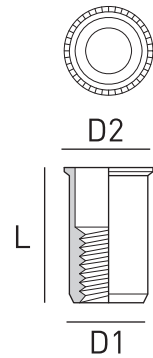

## Installation

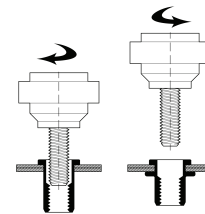

# Blind nuts

NU-BLD-06  
Cylindrical head hex body closed end  
Material: Steel

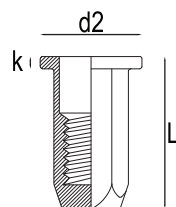

## Specifications

Metric Unit				
Thread	W	L	HOLE WIDTH	GAUGE
M4	6	12	6.1	0.5-3.0
M5	7	14	7.1	0.5-2.5
M6	9	16	9.1	0.5-2.5
M8	11	18	11.1	0.5-2.5
M10	13	22	13.1	0.5-4.0

## Installation

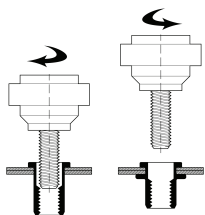

# Blind nuts

NU-BLD-09  
Cylindrical head closed end  
Material: Steel

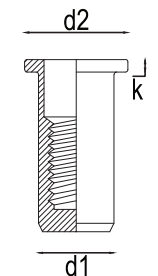

## Specifications

Metric Unit					
Thread	d2	L	d1	GAUGE	
M4	9	14.5 / 15.5 / 16.5	6	0.5-1.5 / 1.5-2.5 / 2.5-3.5	
M5	10	16.0 / 17.0 / 18.0	7	0.5-1.5 / 1.5-2.5 / 2.5-3.5	
M6	12	20.0 / 21.5	9	1.0-2.5 / 2.5-4.0	
M8	14	22.5 / 24.0	11	1.0-2.5 / 2.5-4.0	
M10	16	24.0 / 25.5	13	1.0-2.5 / 2.5-4.0	

## Installation

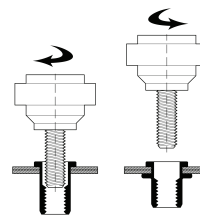



# Cage nuts

NU-CGE-01  
Material: Steel



## Specifications

Thread : #8, #10, #12, 1/4, M4, M5, M6

TYPE	A	B	D	M	E	J	SHEET THICKNESS
S	13.0	13.3	8.4	7.5	6.1	8.3	0.7-1.7
M	13.0	13.3	9.2	8.2	6.2	8.3	1.7-2.2
MW	13.0	13.3	9.2	8.2	6.2	8.3	1.7-2.2
ML	13.0	13.3	9.7	9.3	6.2	8.3	1.7-2.6
MS	13.4	13.0	9.4	8.2	6.1	8.3	1.7-2.7
L	13.2	13.2	10.0	8.2	6.2	8.3	2.2-3.4
XL	13.5	13.3	10.9	8.5	6.1	8.4	3.1-4.2

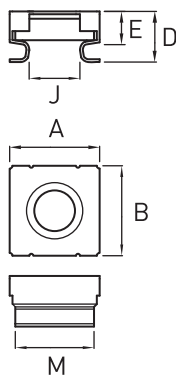

Thread : 5/16, 3/8, M8, M10

TYPE	A	B	D	M	E	J	SHEET THICKNESS
S	16.5	15.8	10.7	10.5	8.0	10.3	0.7-2.0
M	16.6	15.8	11.5	10.6	8.1	10.3	2.1-2.8
ML	16.3	16.3	11.8	10.5	7.6	10.0	2.9-3.3
L	16.5	16.0	13.2	10.6	8.0	10.3	3.3-4.6

# Cap nuts

NU-CAP-02  
Material: Steel / Stainless steel



## Specifications

Imperial Unit			Metric Unit		
Thread	W	M/mm	Thread	W	M/mm
#8	7	8	M4	7	8
#10	8	10	M5	8	10
1/4	10	12	M6	10	12
5/16	13	15	M8	13	15
3/8	16	18	M10	16	18

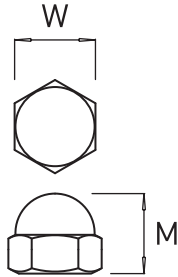

# Cap nuts

Rest options



NU-CAP-03  
Acorn Flange Nuts

# Flange nuts

NU-FLG-01  
Material: Steel / Stainless steel



## Specifications

Unified Unit				Metric Unit			
Thread	W	D	M/mm	Thread	W	D	M/mm
#8	7	10	4.65	M4	7	10	4.65
#10	8	11.8	5	M5	8	11.8	5
1/4	10	14.2	6	M6	10	14.2	6
5/16	13	17.9	8	M8	13	17.9	8
3/8	15	21.8	10	M10	15	21.8	10

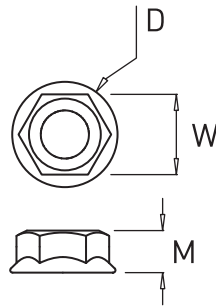

# Hex nuts

NU-HEX-01  
Material: Steel / Stainless steel



## Specifications

Imperial Unit			Metric Unit		
Thread	W	M/mm	Thread	W	M/mm
#8	7	8	M4	7	8
#10	8	10	M5	8	10
1/4	10	12	M6	10	12
5/16	13	15	M8	13	15
3/8	16	18	M10	16	18

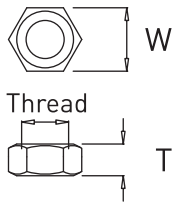

# Hex nuts

Rest options



NU-HEX-02  
Coupling Nuts

# Insert nuts

NU-INT-01  
Type A  
Material: Zamak



## Specifications

Imperial Unit			Metric Unit		
Thread	W	L/mm	Thread	W	L/mm
#5-40	5.9	8	M3-0.5	5.9	8
#8-32	7.9	8	M4-0.7	7.9	8
#8-32	7.9	10	M4-0.7	7.9	10
#10-24	8.0	8	M5-0.8	8.0	8
#10-24	8.2	10	M5-0.8	8.2	10
1/4-20	10.7	8	M6-1.0	10.7	8
1/4-20	10.7	10.5	M6-1.0	10.7	10.5
1/4-20	11.6	13	M6-1.0	11.6	13

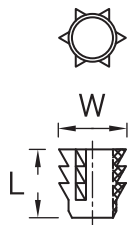

# Insert nuts

NU-INT-02  
Type B  
Material: Zamak



## Specifications

Imperial Unit				Metric Unit			
Thread	W	D	L/mm	Thread	W	D	L/mm
#5-40	5.7	8.5	10	M3-0.5	5.7	8.5	10
#8-32	7.9	10.4	9.5	M4-0.7	7.9	10.4	9.5
#8-32	7.5	10.4	11.5	M4-0.7	7.5	10.4	11.5
#10-24	9.8	13	10.5	M5-0.8	9.8	13	10.5
1/4-20	11.5	14.3	12	M6-1.0	11.5	14.3	12
1/4-20	11.5	14.3	14	M6-1.0	11.5	14.3	14
1/4-20	11.5	14.5	15	M6-1.0	11.5	14.5	15
1/4-20	11.5	14.5	16	M6-1.0	11.5	14.5	16
5/16-18	12	18	16	M8-1.25	12	18	16
5/16-18	12.5	25	20	M8-1.25	12.5	25	20
5/16-18	12.5	18.5	23	M8-1.25	12.5	18.5	23

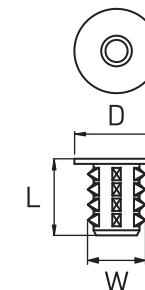

# Insert nuts

NU-INT-08  
Type B closed end  
Material: Zamak



## Specifications

Imperial Unit				Metric Unit			
Thread	W	D	L/mm	Thread	W	D	L/mm
#10-24	9.5	15	15	M5-0.8	9.5	15	15
1/4-20	10.6	17	13.4	M6-1.0	10.6	17	13.4
1/4-20	10.6	17	15	M6-1.0	10.6	17	15

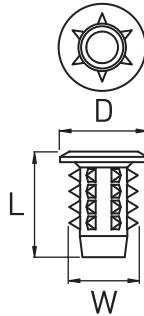

# Insert nuts

NU-INT-03  
Type C  
Material: Zamak



## Specifications

Imperial Unit			Metric Unit		
Thread	W	L/mm	Thread	W	L/mm
#8-32	7.7	9	M4-0.7	7.7	9
#8-32	6.1	9	M4-0.7	6.1	9
#8-32	6.7	10	M4-0.7	6.7	10
#10-24	7.8	10	M5-0.8	7.8	10
#10-24	7.8	12	M5-0.8	7.8	12
1/4-20	9.9	8	M6-1.0	9.9	8
1/4-20	9.7	10	M6-1.0	9.7	10
1/4-20	9.5	12	M6-1.0	9.5	12
1/4-20	10	15	M6-1.0	10	15
1/4-20	12	30	M6-1.0	12	30
5/16-18	12.6	14	M8-1.25	12.6	14
5/16-18	12.1	17	M8-1.25	12.1	17
3/8-16	14.3	18	M10-1.5	14.3	18
3/8-16	15.5	19	M10-1.5	15.5	19
			M12-1.75	17.3	21

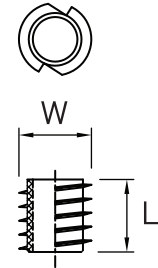

# Insert nuts

NU-INT-04  
Type D  
Material: Zamak



## Specifications

Imperial Unit					Metric Unit				
Thread	W	D	SW	L/mm	Thread	W	D	SW	L/mm
#8-32	6.9	7.7	4	10.5	M4-0.7	6.9	7.7	4	10.5
#8-32	8.1	8.4	4	10	M4-0.7	8.1	8.4	4	10
#8-32	7.2	9.2	4	12	M4-0.7	7.2	9.2	4	12
#10-24	9.7	11	5	9	M5-0.8	9.7	11	5	9
#10-24	10.2	11	5	10	M5-0.8	10.2	11	5	10
#10-24	10.3	11	5	13	M5-0.8	10.3	11	5	13
#10-24	10.8	11	5	20	M5-0.8	10.8	11	5	20
1/4-20	11.5	12	6	8	M6-1.0	11.5	12	6	8
1/4-20	11.4	12	6	10	M6-1.0	11.4	12	6	10
1/4-20	11	12	6	12	M6-1.0	11	12	6	12
1/4-20	10.5	12	6	13	M6-1.0	10.5	12	6	13
1/4-20	11.5	12	6	15	M6-1.0	11.5	12	6	15
1/4-20	11.5	12.5	6	16	M6-1.0	11.5	12.5	6	16
1/4-20	11.5	12	6	18	M6-1.0	11.5	12	6	18
1/4-20	11	12	6	20	M6-1.0	11	12	6	20
1/4-20	11.4	12	6	25	M6-1.0	11.4	12	6	25
5/16-18	14.5	13.6	8	13	M8-1.25	14.5	13.6	8	13
5/16-18	13.6	11.8	8	15	M8-1.25	13.6	11.8	8	15
5/16-18	15	14.3	8	18	M8-1.25	15	14.3	8	18
5/16-18	14.3	13.8	8	20	M8-1.25	14.3	13.8	8	20
5/16-18	14.3	13.3	8	25	M8-1.25	14.3	13.3	8	25
3/8-16	16	15	10	13	M10-1.5	16	15	10	13
3/8-16	20	15	10	15	M10-1.5	20	15	10	15
3/8-16	16	15	10	20	M10-1.5	16	15	10	20
3/8-16	16	15	10	25	M10-1.5	16	15	10	25

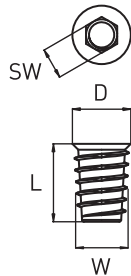

# Insert nuts

NU-INT-06  
Type E  
Material: Zamak



## Specifications

Imperial Unit				Metric Unit			
Thread	D	SW	L/mm	Thread	D	SW	L/mm
#8-32	7.3	4	8	M4-0.7	7.3	4	8
#8-32	7.4	4	10	M4-0.7	7.4	4	10
#10-24	9.3	5	10	M5-0.8	9.3	5	10
#10-24	10.3	5	13	M5-0.8	10.3	5	13
1/4-20	10	6	10	M6-1.0	10	6	10
1/4-20	11.6	6	10	M6-1.0	11.6	6	10
1/4-20	11	6	13	M6-1.0	11	6	13
1/4-20	11.5	6	15	M6-1.0	11.5	6	15
1/4-20	11.7	6	20	M6-1.0	11.7	6	20
5/16-18	13.5	8	13	M8-1.25	13.5	8	13
5/16-18	14	8	18	M8-1.25	14	8	18
5/16-18	13.8	8	20	M8-1.25	13.8	8	20
5/16-18	14	8	25	M8-1.25	14	8	25
3/8-16	15.2	10	20	M10-1.5	15.2	10	20

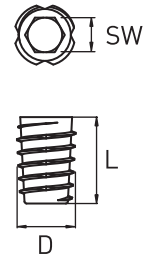

# Insert nuts

NU-INT-04S  
Type D  
Material: Steel



## Specifications

Imperial Unit					Metric Unit				
Thread	D	W	SW	L/mm	Thread	D	W	SW	L/mm
1/4-20	12	10.5	6	10 - 16	M6-1.0	12	10.5	6	10 - 16
5/16-18	14	13.5	8	10 - 20	M8-1.25	14	13.5	8	10 - 20

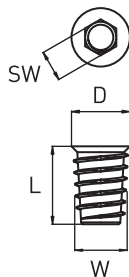

# Insert nuts

NU-INT-06S  
Type E  
Material: Steel



## Specifications

Imperial Unit				Metric Unit			
Thread	D	SW	L/mm	Thread	D	SW	L/mm
1/4-20	12	6	10 - 16	M6-1.0	12	6	10 - 16
5/16-18	14	8	10 - 20	M8-1.25	14	8	10 - 20

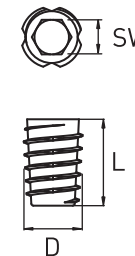



Insert  
nuts / Rest options



NU-KNR-01  
Knurled Insert Nuts



NU-INT-09



NU-INT-10



NU-INT-13



NU-INT-14



NU-INT-11



NU-INT-15



NU-INT-16



NU-INT-17

Insert  
nuts / Rest options

# Lock nuts

NU-NYL-01  
Nylon insert  
Material: Steel



## Specifications

Imperial Unit			Metric Unit		
Thread	W	M/mm	Thread	W	M/mm
#8	7	5	M4	7	5
#10	8	5	M5	8	5
1/4	10	6	M6	10	6
5/16	13	8	M8	13	8
3/8	15	10	M10	15	10

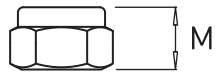

# Lock nuts

Rest options

# Plate nuts

NU-PLT-02  
U type  
Material: Spring steel



## Specifications

Screw	Dimension				Panel Sizes				Boss	Float
	A	B	D1	t	P	D min.	H	HF		
M3-0.5	18.0	11.2	9.0	0.3	0.6-1.0	7.5	4.0	5.5	T	-
M3-0.5	11.5	8.0	6.0	0.3	0.6-1.2	4.5	4.0	4.0	P	No
#4-24	11.5	8.0	6.0	0.45	0.6-1.2	4.5	4.0	4.0	P	No
M4-0.7	20.0	12.7	10.0	0.4	0.7-1.2	8.0	5.0	7.0	T	-
M4-0.7	16.5	9.0	10.0	0.4	0.7-1.2	8.5	5.0	6.0	P	No
#7-16	20.0	12.7	10.0	0.8	0.8-1.5	8.0	5.0	7.0	T	-
#7-16	20.0	12.7	10.0	0.8	1.0-1.6	8.0	5.0	6.0	P	No
#7-16	16.3	11.0	8.3	0.6	1.0-1.6	6.5	5.0	7.0	T	-
#7-16	20.0	12.7	13.0	0.45	2.0-2.7	10.0	5.0	6.0	T	No
#7-16	17.0	11.0	9.1	0.6	0.7-1.6	7.0	5.0	7.7	T	-
#7-16	16.0	11.0	8.0	0.5	2.0-2.5	6.0	5.0	7.7	P	-
#8-18	19.0	9.0	13.0	0.45	2.0-3.0	10.5	5.0	6.0	P	No
M4-0.7	18.0	9.0	12.0	0.4	1.0-1.2	10.0	5.0	6.0	P	No
#7-16	24.0	11.0	17.0	0.6	0.7-1.6	14.5	5.0	7.0	T	-
M5-0.8	20.0	12.7	10.0	0.45	0.7-1.2	8.0	6.5	8.0	T	-
#10-12	20.0	13.0	11.5	0.7	1.0-2.3	9.5	6.5	7.0	T	No
#10-16	19.6	13.0	11.6	0.6	0.7-1.5	9.5	6.5	8.0	P	-
#10-16	32.2	12.7	22.2	0.7	1.0-2.6	19.0	6.5	8.0	P	-
#10-16	16.0	8.0	9.0	0.6	0.7-1.6	7.0	6.5	7.0	P	-
#10-16	16.2	12.7	8.7	0.7	0.8-1.6	7.0	6.5	6.5	T	No
M5-0.8	21.0	12.7	11.5	0.4	1.3-2.0	9.0	6.5	6.5	T	No
#10-16	20.0	13.0	10.0	0.7	1.2-1.6	8.0	6.5	6.5	P	No
M6-1.0	20.0	12.7	10.0	0.5	0.7-1.2	8.0	7.5	9.5	T	-
#14-10	21.8	12.7	11.8	0.8	0.7-1.2	10.0	7.5	7.5	P	No

# Plate nuts

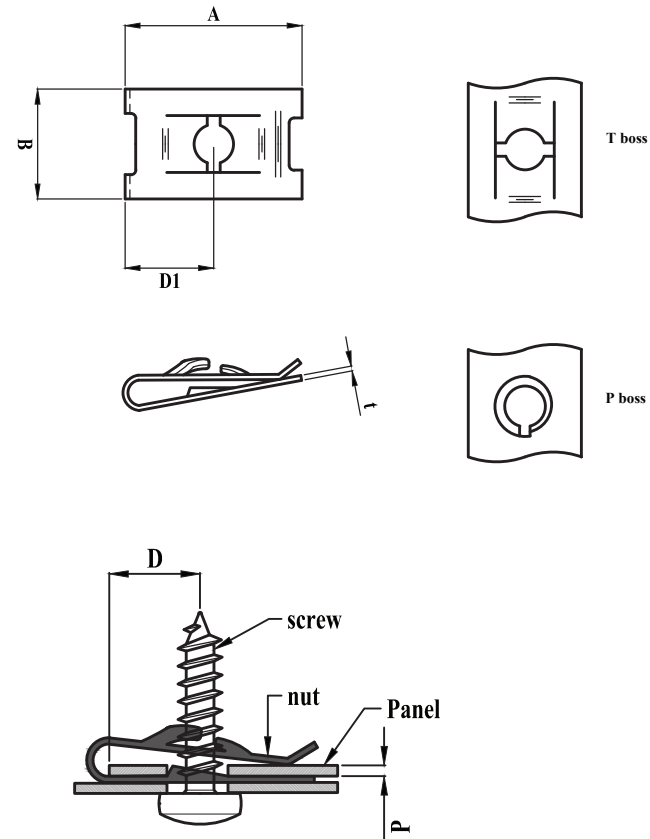

# Plate nuts

NU-PLT-03  
F type  
Material: Spring steel



## Specifications

Screw	Dimension				Panel Sizes	
	A	B	R	t	H upper panel hole	HF lower panel hole
M3-0.5	16	10	40	0.3	3.2	4
M4-0.7	20	13	50	0.4	4.3	5
M5-0.8	20	13	50	0.45	5.3	6
M6-1.0	20	13	50	0.5	6.4	7

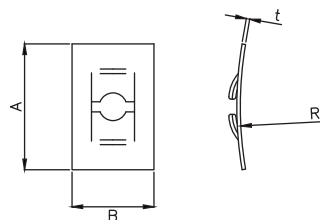

# Plate nuts

Rest options



NU-PLT-01  
Plate nuts  
U type



NU-PLT-06  
Push nut rings

# Rivet nuts

NU-RVT-03  
w/ 4 prongs  
Material: steel



## Specifications

Imperial Unit			Metric Unit		
Thread	D	H	Thread	D	H
5/32	15	12-19	M4	15	12-19
3/16	17	12-19	M5	17	12-19
1/4	18	12-19	M6	18	12-19
5/16	22	12-19	M8	22	12-19
3/8	25	12-19	M10	25	12-19

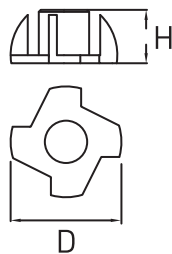

# Rivet nuts

NU-RVT-04  
Material: steel



## Specifications

Imperial Unit			Metric Unit		
Thread	H	L x W / mm	Thread	H	L x W / mm
1/4	12-19	16.3 x 17.5	M6	12-19	16.3 x 17.5
5/16	12-19	21.4 x 22.7	M8	12-19	21.4 x 22.7

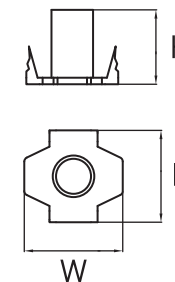

# Rivet nuts

NU-RVT-02  
Material: Steel



## Specifications

Imperial Unit				Metric Unit			
Thread	D2	D1	L	Thread	D	D1	L
1/4	15.5	9.5	15 - 18	M6	15.5	9.5	15 - 18
5/16	15.5	9.5	15 - 18	M8	15.5	9.5	15 - 18

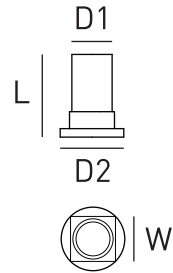

# Rivet nuts

Rest options

# Sleeve nuts

NU-SLV-07  
Material: Steel / Stainless steel



## Specifications

Imperial Unit			Metric Unit		
Thread	D	L	Thread	D	L
1/4	13-20	8-50	M6-1.0	13-20	8-50
5/16	13-20	8-50	M8-1.25	13-20	8-50
3/8	13-20	8-50	M10-1.5	13-20	8-50

Dimension W / d is upon request

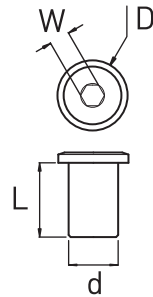

# Sleeve nuts

NU-SLV-09  
Material: Steel / Stainless steel



## Specifications

Imperial Unit			Metric Unit		
Thread	D	L	Thread	D	L
1/4	13-20	8-50	M6-1.0	13-20	8-50
5/16	13-20	8-50	M8-1.25	13-20	8-50
3/8	13-20	8-50	M10-1.5	13-20	8-50

Dimension W & d is upon request

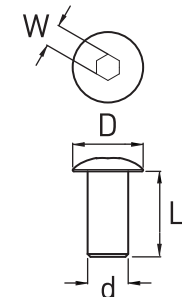

# Sleeve nuts

NU-SLV-10  
Material: Steel / Stainless steel



## Specifications

Imperial Unit			Metric Unit		
Thread	D	L	Thread	D	L
1/4	13-20	8-50	M6-1.0	13-20	8-50
5/16	13-20	8-50	M8-1.25	13-20	8-50
3/8	13-20	8-50	M10-1.5	13-20	8-50

Dimension W / d is upon request

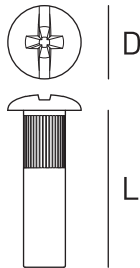

# Sleeve nuts

NU-SLV-01  
Material: Steel / Stainless steel



## Specifications

Imperial Unit			Metric Unit		
Thread	D	L	Thread	D	L
#8	9-12	8-30	M4-0.7	9-12	8-30
#10	10-14	8-30	M5-0.8	10-14	8-30
1/4	13-20	8-50	M6-1.0	13-20	8-50
5/16	13-20	8-50	M8-1.25	13-20	8-50
3/8	13-20	8-50	M10-1.5	13-20	8-50

Dimension W & d is upon request

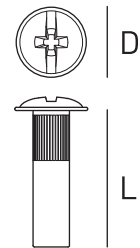



# Sleeve nuts

Rest options



NU-SLV-05



NU-SLV-06



NU-SLV-15



NU-SLV-13



NU-SLV-04



NU-SLV-11



NU-SLV-16



NU-SLV-17



NU-SLV-18  
Diamond Head

# Sleeve nuts

Rest options

# Square nuts

NU-SQR-01 / NU-SQR-02  
Material: Steel



NU-SQR-01

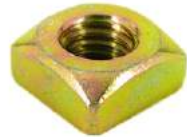

NU-SQR-02  
Single Chamfered

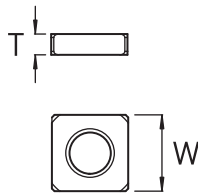

## Specifications

Imperial Unit			Metric Unit		
Thread	W	M/mm	Thread	W	M/mm
#8	7	8	M4	7	8
#10	8	10	M5	8	10
1/4	10	12	M6	10	12
5/16	13	15	M8	13	15
3/8	16	18	M10	16	18

# Square nuts

Rest options

# T nuts

NU-T-01  
w/ 4 prongs  
Material: Steel



## Specifications

Imperial Unit			Metric Unit		
Thread	D	H	Thread	D	H
5/32	15	5-16	M4	15	5-16
3/16	17	6-16	M5	17	6-16
1/4	18	9-16	M6	18	9-16
5/16	22	9-16	M8	22	9-16
3/8	25	9-16	M10	25	9-16

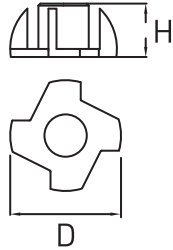

# T nuts

NU-T-02  
Material: Steel



## Specifications

Imperial Unit			Metric Unit		
Thread	H	L x W / mm	Thread	H	L x W / mm
1/4	12-19	16.3 x 17.5	M6	12-19	16.3 x 17.5
5/16	12-19	21.4 x 22.7	M8	12-19	21.4 x 22.7

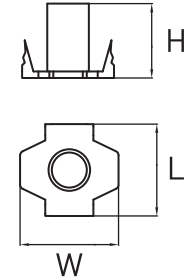

T  
nuts

NU-T-08  
Material: Steel



## Specifications

Imperial Unit			Metric Unit		
Thread	D	H	Thread	D	H
5/32	15	5-16	M4	15	5-16
3/16	17	6-16	M5	17	6-16
1/4	18	9-16	M6	18	9-16
5/16	22	9-16	M8	22	9-16
3/8	25	9-16	M10	25	9-16



T  
nuts

Rest options



NU-T-05  
Zamak



NU-T-06  
Zamak

# Tube connecting nuts

NU-TCN-05  
2 vanes  
Material: Steel



## Specifications

NO.	GAUGE	TUBE I.D.	Thread
TC5/8	18-19	13.8-14.2	1/4
TC3/4C	14-16	14.8-16.1	1/4, 5/16, M6, M8
TC3/4A	16-18	15.7-17.1	1/4, 5/16, M6, M8
TC3/4B	18-21	16.4-17.7	1/4, 5/16, M6, M8
TC7/8C	14-16	17.9-19.3	1/4, 5/16, 3/8, M6, M8, M10
TC7/8A	16-18	18.9-20.2	1/4, 5/16, 3/8, M6, M8, M10
TC7/8B	18-21	19.5-20.9	1/4, 5/16, 3/8, M6, M8, M10
TC1C	14-16	21.4-22.4	1/4, 5/16, 3/8, M6, M8, M10
TC1A	16-18	22.1-23.4	1/4, 5/16, 3/8, M6, M8, M10
TC1B	18-21	22.7-24.0	1/4, 5/16, 3/8, M6, M8, M10
TC1 1/8C	14-16	24.6-25.6	1/4, 5/16, 3/8, M6, M8, M10
TC1 1/8	16-18	25.3-26.6	1/4, 5/16, 3/8, M6, M8, M10
TC30	16-18	26-28	1/4, 5/16, 3/8, M6, M8, M10
TC1 1/4	16-18	28.4-29.8	1/4, 5/16, 3/8, M6, M8, M10
TC1 3/8	16-18	31.7-32.9	1/4, 5/16, 3/8, M6, M8, M10
TC1 1/2	16-18	34.8-36.1	1/4, 5/16, 3/8, M6, M8, M10
TC40	16-18	36-38	1/4, 5/16, 3/8, M6, M8, M10
TC1 5/8	16-18	37.3-39.3	1/4, 5/16, 3/8, M6, M8, M10
TC1 3/4	16-18	41.4-42.4	1/4, 5/16, 3/8, M6, M8, M10
TC1 7/8	16-18	43.7-45.7	1/4, 5/16, 3/8, M6, M8, M10
TC2	14-18	47.5-48.8	1/4, 5/16, 3/8, M6, M8, M10
TC2 1/4	14-18	53-55	1/4, 5/16, 3/8, M6, M8, M10
TC60	14-18	56-58	1/4, 5/16, 3/8, M6, M8, M10
TC2 1/2	14-18	59.5-61.5	1/4, 5/16, 3/8, M6, M8, M10
TC65	14-18	61-63	1/4, 5/16, 3/8, M6, M8, M10
TC3	14-18	72.2-74.2	1/4, 5/16, 3/8, M6, M8, M10

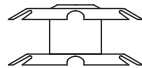
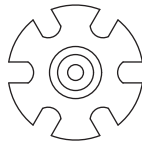

# Tube connecting nuts

NU-TCN-04  
3 vanes  
Material: Steel



## Specifications

NO.	GAUGE	TUBE I.D.	Thread
3TC5/8	18-19	13.8-14.2	1/4
3TC3/4C	14-16	14.8-16.1	1/4, 5/16, M6, M8
3TC3/4A	16-18	15.7-17.1	1/4, 5/16, M6, M8
3TC3/4B	18-21	16.4-17.7	1/4, 5/16, M6, M8
3TC7/8C	14-16	17.9-19.3	1/4, 5/16, 3/8, M6, M8, M10
3TC7/8A	16-18	18.9-20.2	1/4, 5/16, 3/8, M6, M8, M10
3TC7/8B	18-21	19.5-20.9	1/4, 5/16, 3/8, M6, M8, M10
3TC1C	14-16	21.4-22.4	1/4, 5/16, 3/8, M6, M8, M10
3TC1A	16-18	22.1-23.4	1/4, 5/16, 3/8, M6, M8, M10
3TC1B	18-21	22.7-24.0	1/4, 5/16, 3/8, M6, M8, M10
3TC1 1/8C	14-16	24.6-25.6	1/4, 5/16, 3/8, M6, M8, M10
3TC1 1/8	16-18	25.3-26.6	1/4, 5/16, 3/8, M6, M8, M10
3TC30	16-18	26-28	1/4, 5/16, 3/8, M6, M8, M10
3TC1 1/4	16-18	28.4-29.8	1/4, 5/16, 3/8, M6, M8, M10
3TC1 3/8	16-18	31.7-32.9	1/4, 5/16, 3/8, M6, M8, M10
3TC1 1/2	16-18	34.8-36.1	1/4, 5/16, 3/8, M6, M8, M10
3TC40	16-18	36-38	1/4, 5/16, 3/8, M6, M8, M10
3TC1 5/8	16-18	37.3-39.3	1/4, 5/16, 3/8, M6, M8, M10
3TC1 3/4	16-18	41.4-42.4	1/4, 5/16, 3/8, M6, M8, M10
3TC1 7/8	16-18	43.7-45.7	1/4, 5/16, 3/8, M6, M8, M10
3TC2	14-18	47.5-48.8	1/4, 5/16, 3/8, M6, M8, M10
3TC2 1/4	14-18	53-55	1/4, 5/16, 3/8, M6, M8, M10
3TC60	14-18	56-58	1/4, 5/16, 3/8, M6, M8, M10
3TC2 1/2	14-18	59.5-61.5	1/4, 5/16, 3/8, M6, M8, M10
3TC65	14-18	61-63	1/4, 5/16, 3/8, M6, M8, M10
3TC3	14-18	72.2-74.2	1/4, 5/16, 3/8, M6, M8, M10

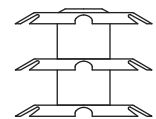
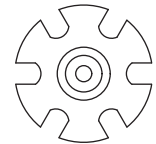

# Tube connecting nuts

NU-TCN-01  
For round tube  
1 vane w/ cover  
Material: Steel



## Specifications

NO.	GAUGE	TUBE I.D.	Thread
TCR5/8	18-19	13.8-14.2	1/4
TCR3/4C	14-16	14.8-16.1	1/4, 5/16, M6, M8
TCR3/4A	16-18	15.7-17.1	1/4, 5/16, M6, M8
TCR3/4B	18-21	16.4-17.7	1/4, 5/16, M6, M8
TCR7/8C	14-16	17.9-19.3	1/4, 5/16, 3/8, M6, M8, M10
TCR7/8A	16-18	18.9-20.2	1/4, 5/16, 3/8, M6, M8, M10
TCR7/8B	18-21	19.5-20.9	1/4, 5/16, 3/8, M6, M8, M10
TCR1C	14-16	21.4-22.4	1/4, 5/16, 3/8, M6, M8, M10
TCR1A	16-18	22.1-23.4	1/4, 5/16, 3/8, M6, M8, M10
TCR1B	18-21	22.7-24.0	1/4, 5/16, 3/8, M6, M8, M10
TCR1 1/8C	14-16	24.6-25.6	1/4, 5/16, 3/8, M6, M8, M10
TCR1 1/8	16-18	25.3-26.6	1/4, 5/16, 3/8, M6, M8, M10
TCR30	16-18	26-28	1/4, 5/16, 3/8, M6, M8, M10
TCR1 1/4	16-18	28.4-29.8	1/4, 5/16, 3/8, M6, M8, M10
TCR1 3/8	16-18	31.7-32.9	1/4, 5/16, 3/8, M6, M8, M10
TCR1 1/2	16-18	34.8-36.1	1/4, 5/16, 3/8, M6, M8, M10
TCR40	16-18	36-38	1/4, 5/16, 3/8, M6, M8, M10
TCR1 5/8	16-18	37.3-39.3	1/4, 5/16, 3/8, M6, M8, M10
TCR1 3/4	16-18	41.4-42.4	1/4, 5/16, 3/8, M6, M8, M10
TCR1 7/8	16-18	43.7-45.7	1/4, 5/16, 3/8, M6, M8, M10
TCR2	14-18	47.5-48.8	1/4, 5/16, 3/8, M6, M8, M10
TCR2 1/4	14-18	53-55	1/4, 5/16, 3/8, M6, M8, M10
TCR60	14-18	56-58	1/4, 5/16, 3/8, M6, M8, M10
TCR2 1/2	14-18	59.5-61.5	1/4, 5/16, 3/8, M6, M8, M10
TCR65	14-18	61-63	1/4, 5/16, 3/8, M6, M8, M10
TCR3	14-18	72.2-74.2	1/4, 5/16, 3/8, M6, M8, M10

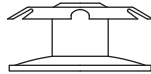
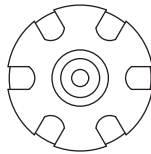

# Tube connecting nuts

NU-TCN-02  
For round tube  
2 vanes w/ cover  
Material: Steel



## Specifications

NO.	GAUGE	TUBE I.D.	Thread
2TCR5/8	18-19	13.8-14.2	1/4
2TCR3/4C	14-16	14.8-16.1	1/4, 5/16, M6, M8
2TCR3/4A	16-18	15.7-17.1	1/4, 5/16, M6, M8
2TCR3/4B	18-21	16.4-17.7	1/4, 5/16, M6, M8
2TCR7/8C	14-16	17.9-19.3	1/4, 5/16, 3/8, M6, M8, M10
2TCR7/8A	16-18	18.9-20.2	1/4, 5/16, 3/8, M6, M8, M10
2TCR7/8B	18-21	19.5-20.9	1/4, 5/16, 3/8, M6, M8, M10
2TCR1C	14-16	21.4-22.4	1/4, 5/16, 3/8, M6, M8, M10
2TCR1A	16-18	22.1-23.4	1/4, 5/16, 3/8, M6, M8, M10
2TCR1B	18-21	22.7-24.0	1/4, 5/16, 3/8, M6, M8, M10
2TCR1 1/8C	14-16	24.6-25.6	1/4, 5/16, 3/8, M6, M8, M10
2TCR1 1/8	16-18	25.3-26.6	1/4, 5/16, 3/8, M6, M8, M10
2TCR30	16-18	26-28	1/4, 5/16, 3/8, M6, M8, M10
2TCR1 1/4	16-18	28.4-29.8	1/4, 5/16, 3/8, M6, M8, M10
2TCR1 3/8	16-18	31.7-32.9	1/4, 5/16, 3/8, M6, M8, M10
2TCR1 1/2	16-18	34.8-36.1	1/4, 5/16, 3/8, M6, M8, M10
2TCR40	16-18	36-38	1/4, 5/16, 3/8, M6, M8, M10
2TCR1 5/8	16-18	37.3-39.3	1/4, 5/16, 3/8, M6, M8, M10
2TCR1 3/4	16-18	41.4-42.4	1/4, 5/16, 3/8, M6, M8, M10
2TCR1 7/8	16-18	43.7-45.7	1/4, 5/16, 3/8, M6, M8, M10
2TCR2	14-18	47.5-48.8	1/4, 5/16, 3/8, M6, M8, M10
2TCR2 1/4	14-18	53-55	1/4, 5/16, 3/8, M6, M8, M10
2TCR60	14-18	56-58	1/4, 5/16, 3/8, M6, M8, M10
2TCR2 1/2	14-18	59.5-61.5	1/4, 5/16, 3/8, M6, M8, M10
2TCR65	14-18	61-63	1/4, 5/16, 3/8, M6, M8, M10
2TCR3	14-18	72.2-74.2	1/4, 5/16, 3/8, M6, M8, M10

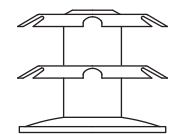
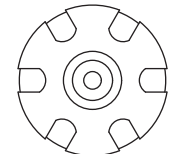

## Tube connecting nuts

NU-TCN-03  
For square tube  
1 vane w/ cover  
Material: Steel



### Specifications

NO.	GAUGE	TUBE I.D.	Thread
TCS19x19	16-18	15.7-17.1	1/4, 5/16, M6, M8
TCS22x22	16-18	18.9-20.2	1/4, 5/16, 3/8, M6, M8, M10
TCS25x25	16-18	22.1-23.4	1/4, 5/16, 3/8, M6, M8, M10
TCS28x28	16-18	25.3-26.6	1/4, 5/16, 3/8, M6, M8, M10
TCS30x30	16-18	26.4-27.8	1/4, 5/16, 3/8, M6, M8, M10
TCS32x32	16-18	28.4-29.8	1/4, 5/16, 3/8, M6, M8, M10
TCS38x38	16-18	34.8-36.1	1/4, 5/16, 3/8, M6, M8, M10
TCS45x45	16-18	41.4-42.4	1/4, 5/16, 3/8, M6, M8, M10
TCS50x50	16-18	47.5-48.8	1/4, 5/16, 3/8, M6, M8, M10

## Tube connecting nuts

NU-TCN-06  
For square tube  
2 vanes w/ cover  
Fits caster stem Ø7/16" \* 1 1/2"  
Material: Steel



### Specifications

NO.	GAUGE	TUBE I.D.	Thread
2TCS19x19	16-18	15.7-17.1	1/4, 5/16, M6, M8
2TCS22x22	16-18	18.9-20.2	1/4, 5/16, 3/8, M6, M8, M10
2TCS25x25	16-18	22.1-23.4	1/4, 5/16, 3/8, M6, M8, M10
2TCS28x28	16-18	25.3-26.6	1/4, 5/16, 3/8, M6, M8, M10
2TCS30x30	16-18	26.4-27.8	1/4, 5/16, 3/8, M6, M8, M10
2TCS32x32	16-18	28.4-29.8	1/4, 5/16, 3/8, M6, M8, M10
2TCS38x38	16-18	34.8-36.1	1/4, 5/16, 3/8, M6, M8, M10
2TCS45x45	16-18	41.4-42.4	1/4, 5/16, 3/8, M6, M8, M10
2TCS50x50	16-18	47.5-48.8	1/4, 5/16, 3/8, M6, M8, M10

## Tube connecting nuts

NU-TCN-07  
For square tube  
2 vanes  
Material: Steel



### Specifications

NO.	GAUGE	TUBE I.D.	Thread
STC19x19	16-18	15.7-17.1	1/4, 5/16, M6, M8
STC20x20	16-18	16.7-18.1	1/4, 5/16, M6, M8
STC22x22	16-18	18.9-20.2	1/4, 5/16, M6, M8
STC25x25	16-18	22.1-23.4	1/4, 5/16, 3/8, M6, M8, M10
STC30x30	16-18	28.4-29.8	1/4, 5/16, 3/8, M6, M8, M10
STC32x32	16-18	28.0-30.0	1/4, 5/16, 3/8, M6, M8, M10
STC38x38	16-18	34.8-36.1	1/4, 5/16, 3/8, M6, M8, M10

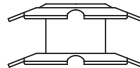
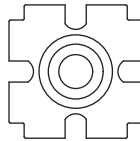

## Tube connecting nuts

NU-TCN-11  
For Rectangle tube  
2 vanes w/ 2 threaded holes  
Material: Steel



### Specifications

NO.	WxL	Thread
2RT-14.5x44.5	14.5x44.5	1/4, M6
2RT-20x40	20x40	1/4, M6
2RT-25x50	25x50	1/4, M6

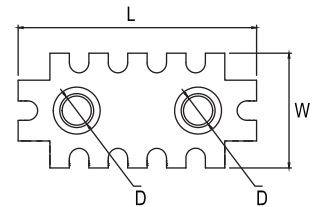
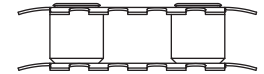



## Tube connecting nuts

NU-TCN-10  
For round tube  
1 vane w/ U shape cover  
Material: Steel

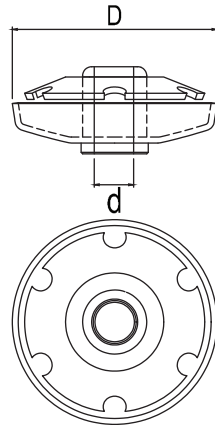

## Specifications

NO.	TUBE O.D.	Thread
U-5/8	5/8" (15.88MM)	1/4, M6
U-3/4	3/4" (19.05MM)	1/4, 5/16, M6, M8
U-7/8	7/8" (22.22MM)	1/4, 5/16, 3/8, M6, M8, M10
U-1	1" (25.4MM)	1/4, 5/16, 3/8, M6, M8, M10
U-1 1/8	1 1/8" (28.57MM)	1/4, 5/16, 3/8, M6, M8, M10
U-1 1/4	1 1/4" (31.75MM)	1/4, 5/16, 3/8, M6, M8, M10
U-1 1/2	1 1/2" (38.1MM)	1/4, 5/16, 3/8, M6, M8, M10
U-2	2" (50.8MM)	1/4, 5/16, 3/8, M6, M8, M10

## Tube connecting nuts

Rest options



NU-TCN-09  
STC1"x2"  
3/8", M10  
Thickness 1.5-1.6MM

# Weld nuts

NU-WLD-01  
Material: Steel



## Specifications

Imperial Unit			Metric Unit		
Thread	W	H/mm	Thread	W	H/mm
#8-32	8	3.2	M4-0.7	8	3.2
#10-24	9	4	M5-0.8	9	4
1/4-20	10	5	M6-1.0	10	5
5/16-18	12	6.5	M8-1.25	12	6.5
3/8-16	14	8	M10-1.5	14	8
1/2-13	17	10	M12-1.75	17	10



# Weld nuts

NU-WLD-02  
Material: Steel



## Specifications

Imperial Unit			Metric Unit		
Thread	W	H/mm	Thread	W	H/mm
#8-32	7	3.5	M4-0.7	7	3.5
#10-24	9	4.2	M5-0.8	9	4.2
1/4-20	10	5	M6-1.0	10	5
5/16-18	14	6.5	M8-1.25	14	6.5
3/8-16	17	8	M10-1.5	17	8
1/2-12	19	9.5	M12-1.75	19	9.5



# Wing nuts

NU-WNG-01  
Material: Steel / Stainless steel



## Specifications

Imperial Unit			Metric Unit		
Thread	W	H/mm	Thread	W	H/mm
5/32-32	21	8	M4-0.7	21	8
3/16-24	21	8	M5-0.8	21	8
1/4-20	26	9	M6-1.0	26	9
5/16-18	29	12	M8-1.25	29	12
3/8-16	37	13.5	M10-1.5	37	13.5
7/16-14	44	17	M12-1.75	44	17
1/2-13	44	17			

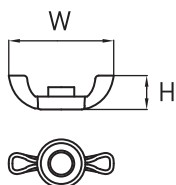

# Wing nuts

NU-WNG-03  
Material: Zamak



## Specifications

Imperial Unit			Metric Unit		
Thread	W	H/mm	Thread	W	H/mm
1/8-40	16	8.3	M3-0.5	16	8.3
1/8-40	20	9.8	M3-0.5	20	9.8
5/32-32	20	9.8	M4-0.7	20	9.8
5/32-32	21	10.7	M4-0.7	21	10.7
3/16-24	20	9.8	M5-0.8	20	9.8
3/16-24	21	10.8	M5-0.8	21	10.8
3/16-24	25	12.5	M5-0.8	25	12.5
1/4-20	21	10.1	M6-1.0	21	10.1
1/4-20	25	12.5	M6-1.0	25	12.5
1/4-20	28	12.7	M6-1.0	28	12.7
5/16-18	28	12.7	M8-1.25	28	12.7
3/8-16	28	14.2	M10-1.5	28	14.2
1/2-12	48	22.8	M12-1.75	48	22.8

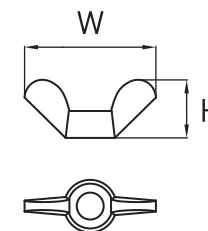

# Wing nuts

NU-WNG-09  
 Forged wing nut  
 Material: Steel / Stainless steel / brass



## Specifications

Imperial Unit			Metric Unit		
Thread	W	H/mm	Thread	W	H/mm
#6-32	21.5	11	M3-0.5	21.5	11
#8-32	21.5	11	M4-0.7	21.5	11
#10-24	21.5	11	M5-0.8	21.5	11
1/4-20	26.5	13	M6-1.0	26.5	13
5/16-18	30.0	16	M8-1.25	30.0	16
3/8-16	36.0	19	M10-1.5	36.0	19
1/2-13	48.0	25	M12-1.75	48.0	25
5/8-11	68.0	35	M16-2.0	68.0	35
3/4-10	68.0	35			

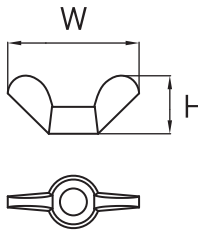

# Wing nuts

Rest options



NU-WNG-02  
 W22xH12xD15.5  
 W28.5xH14.5xD22  
 1/4-20, M6-1.0



NU-WNG-05  
 W30.5xH16xD13  
 5/16-18, M8-1.25



NU-WNG-06  
 W22xH14xD12.5  
 #10-24, M5-0.8



NU-WNG-04  
 W29xH23xD10.7  
 #10-24, M5-0.8



NU-WNG-08  
 W25.4xH8xD13  
 #8-32, M4-0.7



NU-WNG-07  
 W37.5xH9.5xD14  
 #10-24, M5-0.8